

SET-UP DIAGRAM: Mt. Carmel Community Life Center Gymnasium

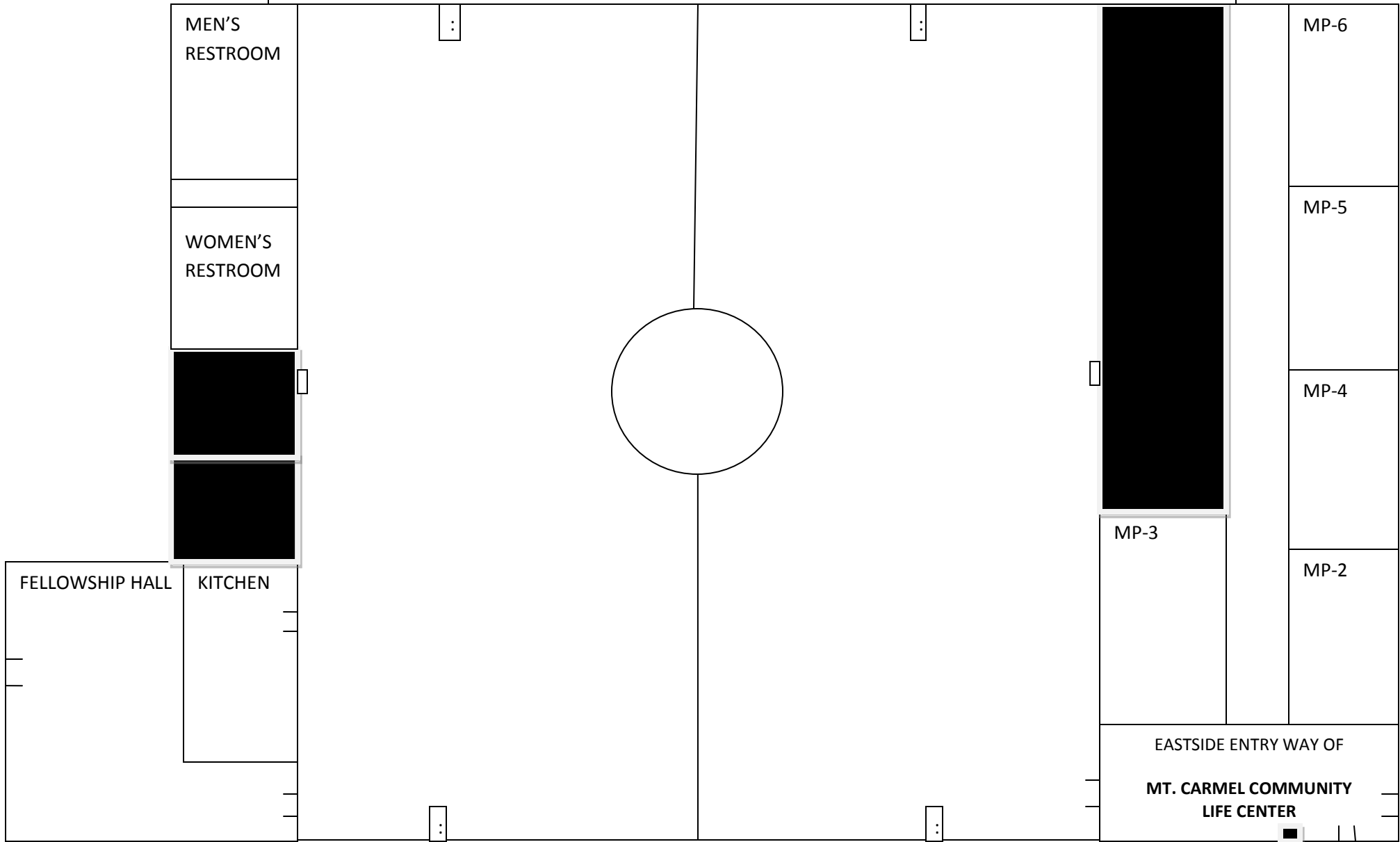

(Note: This diagram is not "drawn to scale")

DIAGRAM KEY: Please use the following symbols to represent the respective items for drawing instructions.

X = **folding chairs** (181 chairs available for use)

○ = **6 ft. round tables** (15 available); 4 ft. round tables (2 available)

□ = **8 ft. rectangular tables** (28 available)

⌋ = **partition** (4 available)

= **bleachers** (4 available)

△ = **dry erase boards** (3 short; 1 long available)

* = **extension chord**

◇ = **screen/media**